

Otello 6 HD FullSpectrum +

Last update:
29/03/2023



Otello 6 HD + with 8 leaf barndoor

Introducing

● Developed to offer the best solution in the stage lighting field focussing on **theatre and TV studios applications**, Otello Led Fresnel incorporates all traditional characteristics of a Fresnel light such as the **distinctive soft-edged** and **very wide beam** and the **smooth and homogeneous light field**.

The improved **HD electronic** with an advanced LED controller guarantees a smooth 20 bit dimming and a superlative **color mixing**.

Next to the traditional manual or P.O. option, Otello offers an optional motorized zoom, which together with a modern design and Oled display with on-board selector for quick setting represents the state of the art in terms of LED Fresnel range. The family consists of 2 fixtures with lenses of 150 mm (5,9 inch) and 200 mm (7,87 inch). All variants include COB, VariWhite, Studio and FullSpectrum 6 LEDs in 3 power steps.

● **FullSpectrum** : 2.700 – 20.000 K (CRI average > 95); Red, Green, Blue, Cyan, Lime, Amber color mixing with Green-Magenta adjustment

● **VariWhite | Tungsten | Daylight**: white engines with the Tungsten and Daylight COB LED calibrated respectively at 3.000 K and 5.600 K CCT and a tunable white source ranging from 2.800 to 6.500 K (CRI > 94) for the VariWhite version

Key Features



- Red, Green, Blue, Cyan, Lime, Amber light source, 20 bit color mixing
- Green-Magenta adjustment
- Color mixing with hue and saturation control



- High CRI 97 @ 3.200 K, CRI 96 @ 5.600 K



- CCT 2.700K → 20.000 K



- Fresnel lens (diameter: 150 mm / 5.9 in)
- Zoom range from 8° to 43° half peak angle
- Available with Manual or Motorized Zoom



- Extruded aluminum, flame-retardant technopolymer reinforced with fiberglass



- Custom color on request (optional)



- Manual (standard) or Pole Operated Pan-Tilt (optional)

General	
● LED Source	RGBCLA COB LED (Red, Green, Blue, Cyan, Lime, Amber) - Color mixing with hue and saturation control
● CCT Range	●●●●● CCT from 2.700 K to 10.000 K (through DMX) or up to 20.000 K (through Display)
● Color Rendition Average	CRI 97 @ 3.200 K, CRI 96 @ 5.600 K
● Dimming	8 or 16 bit, 5 selectable curves: Exponential, Logarithmic, Linear, Halo and Standard
● Dimming Smooth Selection	Fast, Slow and Very Slow
● Strobe	Electronic strobe, synchronized, random, pulse effect
● Lens	Glass Fresnel lens (diameter: 150 mm / 5.9 in)
● Optical	Zoom range from 8° to 43° half peak angle (motorized, manual or PO zoom available)
● Green-Magenta adjustment	Continuously adjustable (Full Minusgreen to Full Plusgreen)
● Color saturation function	Generated colors fades to White tone selected with the CCT channel
● Dim to Warm function	Halogen lamp dimmer simulation
● Camera flicker control/Hz range	Yes: 20.000 Hz
● Calibrated Cob	Yes
● L80 Rating (hours to 80% output)	50.000 Hours
Electrical	
● Voltage Input	80-264V, 50-60 Hz, Auto-sensing
● Power Consumption	190 W Maximum - 0.84 A at 230V, 1.68 A at 115V - $\cos\phi$: 0.98 (manual / P.O. zoom) 200 W Maximum - 0.88 A at 230V, 1.77 A at 115V - $\cos\phi$: 0.98 (motorized zoom)
● Power Connection	In and Out PowerCON TRUE1 Top connectors to feed up to 8 (at 230V) or 4 (at 115V) fixtures
● Data Connection	In and Out DMX 5 pin locking XLR connectors
Thermal	
● Ambient Operating Temperature	0°C - +40°C (32°F - 104°F)
● Fan (controllable)	Yes, 4 different settings: Silent, Studio, Auto, DMX Regulated
Control Options	
● Protocols	DMX512A, RDM (Remote Device Management), Wireless (Optional By LumenRadio)
● RDM configuration	Yes
● DMX Channels	Manual / PO zoom version: 16 / 7 / 1 / Studio mode / RGB mode / fine RGB mode / Sunrise mode Motorized zoom version: 17 / 8 / Studio mode / RGB mode / fine RGB mode / Sunrise mode
● Display	Graphic OLED with on-board selector for quick setting
● Firmware upgrade	Through DMX with RDM Upgrade USB interface (code AC10011A001)
Physical	
● Yoke	Manual (standard) or Pole Operated Pan-Tilt (optional)
● Materials	Extruded aluminum, flame-retardant technopolymer reinforced with fiberglass
● Weight	With Manual Yoke: 9.5 Kg / 20.94 lbs - With Pole Operated Yoke: 11 Kg / 24.25 lbs
● Length	425.6 mm / 16.76 in
● Width	With Manual Yoke: 277.7 mm / 10.93 in - With Pole Operated Yoke: 370 mm / 14.56 in
● Height without yoke	267.3 mm / 10.52 in
● Height with yoke	With Manual Yoke: 384.2 mm / 15.13 in - With Pole Operated Yoke: 558 mm / 21.96 in
● IP Rating	IP20
● Color options	Black (standard), custom color on request (optional)
Included accessories	
BC10044A001	8-Leaf Barndoor
GKIT17 (USA) / GKIT16 (EU)	1.5 m power cable with PowerCON TRUE1 Top and bare ends
BC10044A005	Color frame holder



Otello 6 HD + (manual zoom)
Rear Panel with the new OLED
display



Otello 6 HD + with
Pole Operated Yoke and Pole Operated
Zoom

Otello 6 HD+ PO version / Rear Panel

DMX Charts - Manual version

16 Channels

- 01 → Master Dimmer
- 02 → Red
- 03 → Green
- 04 → Blue
- 05 → Cyan
- 06 → Lime
- 07 → Amber
- 08 → Strobe Effect
- 09 → Dimmer Fine
- 10 → Special Functions
- 11 → Red Tone
- 12 → Green Tone
- 13 → Blue Tone
- 14 → White Tone
- 15 → Green Saturation
- 16 → Saturation

7 Channels

- 01 → Master Dimmer
- 02 → Red
- 03 → Green
- 04 → Blue
- 05 → Cyan
- 06 → Lime
- 07 → Amber

Studio Mode

- 01 → Master Dimmer
- 02 → White Tone
- 03 → Green Saturation
- 04 → Saturation
- 05 → Hue
- 06 → Dimmer Fine
- 07 → Special Functions

1 Channel

- 01 → Master Dimmer - Color
Temperature Settable by Display

RGB Mode

- 01 → Master Dimmer
- 02 → Dimmer Fine
- 03 → Red
- 04 → Green
- 05 → Blue
- 06 → White Tone
- 07 → Saturation
- 08 → Strobe Effect
- 09 → Special Functions

Fine RGB Mode

- 01 → Master Dimmer
- 02 → Dimmer Fine
- 03 → Red
- 04 → Red Fine
- 05 → Green
- 06 → Green Fine
- 07 → Blue
- 08 → Blue Fine
- 09 → White Tone
- 10 → Saturation
- 11 → Strobe
- 12 → Special Functions

Sunrise Mode

- 01 → Master Dimmer
- 02 → Dimmer Fine
- 03 → Proportional CCT
- 04 → Step CCT
- 05 → Green Saturation
- 06 → Special Functions

17 Channels

- 01 → Master Dimmer
- 02 → Red
- 03 → Green
- 04 → Blue
- 05 → Cyan
- 06 → Lime
- 07 → Amber
- 08 → Strobe Effect
- 09 → Dimmer Fine
- 10 → Special Functions
- 11 → Red Tone
- 12 → Green Tone
- 13 → Blue Tone
- 14 → White Tone
- 15 → Green Saturation
- 16 → Saturation
- 17 → Zoom

8 Channels

- 01 → Master Dimmer
- 02 → Red
- 03 → Green
- 04 → Blue
- 05 → Cyan
- 06 → Lime
- 07 → Amber
- 08 → Zoom

Studio Mode

- 01 → Master Dimmer
- 02 → White Tone
- 03 → Green Saturation
- 04 → Saturation
- 05 → Hue
- 06 → Dimmer Fine
- 07 → Special Functions
- 08 → Zoom

RGB Mode

- 01 → Master Dimmer
- 02 → Dimmer Fine
- 03 → Red
- 04 → Green
- 05 → Blue
- 06 → White Tone
- 07 → Saturation
- 08 → Strobe Effect
- 09 → Special Functions
- 10 → Zoom

Fine RGB Mode

- 01 → Master Dimmer
- 02 → Dimmer Fine
- 03 → Red
- 04 → Red Fine
- 05 → Green
- 06 → Green Fine
- 07 → Blue
- 08 → Blue Fine
- 09 → White Tone
- 10 → Saturation
- 11 → Strobe
- 12 → Special Functions
- 13 → Zoom

Sunrise Mode

- 01 → Master Dimmer
- 02 → Dimmer Fine
- 03 → Proportional CCT
- 04 → Step CCT
- 05 → Green Saturation
- 06 → Special Functions
- 07 → Zoom

Drawing Size - Manual Yoke Version

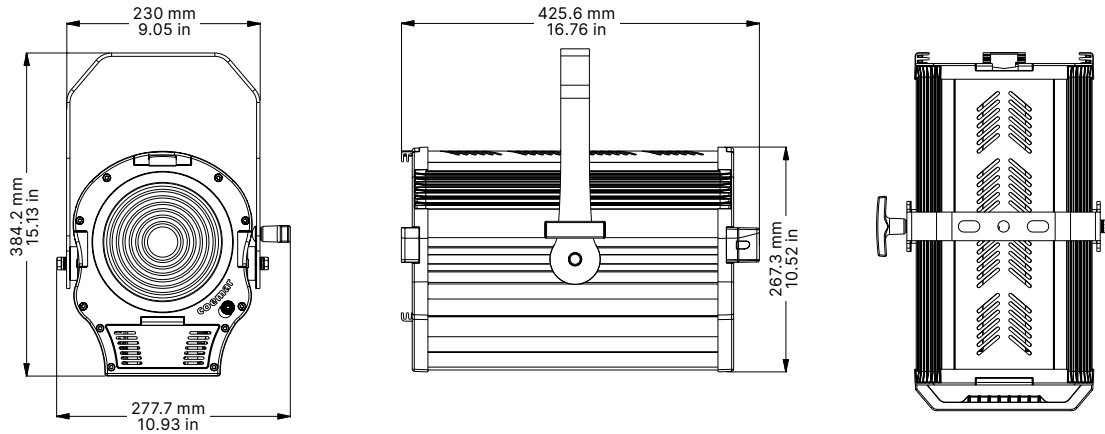

Drawing Size - Pole operated Yoke Version

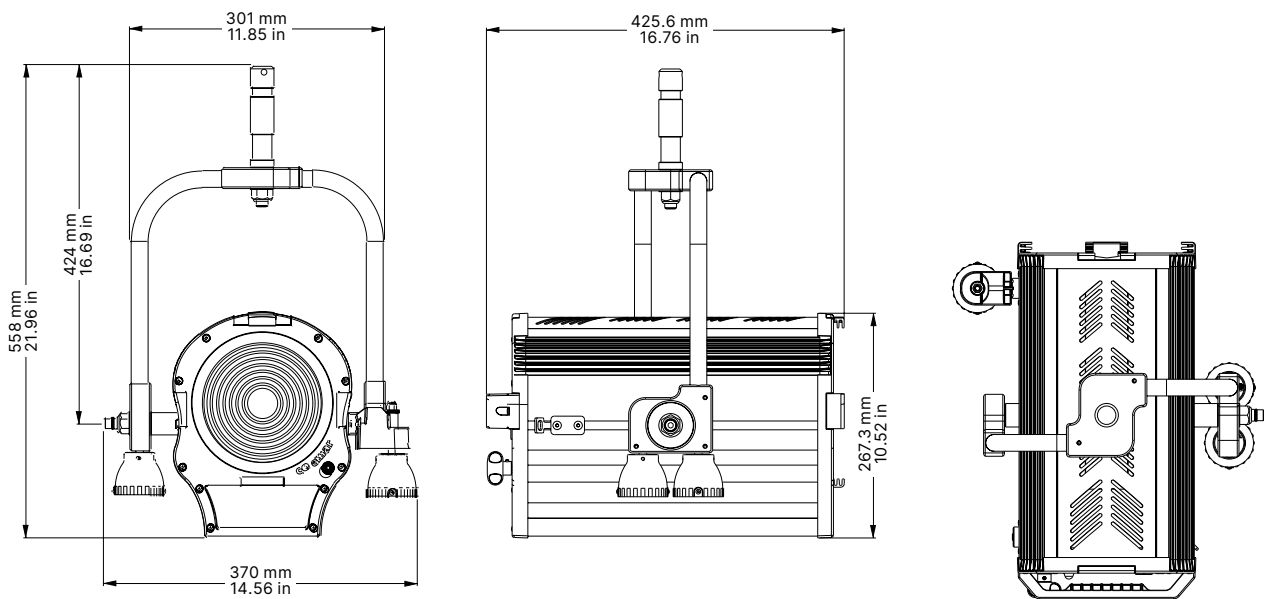

Models

Product	Code
Otello 6 HD FullSpectrum + Manual Yoke, Manual Zoom	F144Q090M
Otello 6 HD FullSpectrum + Manual Yoke, Motorized Zoom	F144Q000M
Otello 6 HD FullSpectrum + Pole Operated	F144Q010M

Otello 6 HD FullSpectrum +

Optic: Minimum Zoom

Distance(m)		1	2	3	4	5	6	7	8	9	10	
lux	RED	10.016	2.504	1.113	626	401	278	204	157	124	100	
	GREEN	21.048	5.262	2.339	1.316	842	585	430	329	260	210	
	BLUE	4.932	1.233	548	308	197	137	101	77	61	49	
	CYAN	12.672	3.168	1.408	792	507	352	259	198	156	127	
	LIME	59.036	14.759	6.560	3.690	2.361	1.640	1.205	922	729	590	
	AMBER	36.148	9.037	4.016	2.259	1.446	1.004	738	565	446	361	
	FULL	80.988	20.247	8.999	5.062	3.240	2.250	1.653	1.256	1.000	810	
	3.200K	90.296	22.574	10.033	5.644	3.612	2.508	1.843	1.411	1.115	903	
	5.600K	93.004	23.251	10.334	5.813	3.720	2.583	1.893	1.453	1.148	930	
1/2 P.A. Ø (m)		0,15	0,30	0,45	0,60	0,75	0,90	1,05	1,20	1,35	1,50	
1/10 P.A. Ø (m)		0.36	0,72	1,08	1,44	1,80	2,16	2,52	2,88	3,24	3,60	
lux	3.200K	CRI 96.8	TLCI 94.6									
	5.600K	CRI 97.3	TLCI 96.8									

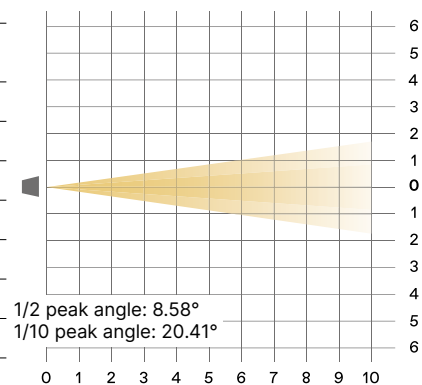

Optic: Medium Zoom

Distance(m)		1	2	3	4	5	6	7	8	9	10	
lux	RED	2.580	645	287	161	103	72	53	40	32	26	
	GREEN	5.788	1.447	643	362	232	161	118	90	71	58	
	BLUE	1.432	358	159	90	57	40	29	22	18	14	
	CYAN	3.380	845	376	211	135	94	69	53	42	34	
	LIME	16.332	4.083	1.815	1.021	653	454	333	255	202	163	
	AMBER	9.904	2.476	1.100	619	396	275	202	155	122	99	
	FULL	22.208	5.552	2.468	1.388	888	617	453	347	274	222	
	3.200K	25.164	6.291	2.796	1.573	1.007	699	514	393	311	252	
	5.600K	25.544	6.386	2.838	1.597	1.022	710	521	399	315	255	
1/2 P.A. Ø (m)		0,50	1,01	0,51	2,02	2,52	3,03	3,53	4,04	4,54	5,05	
1/10 P.A. Ø (m)		0,74	1,48	2,22	2,96	3,70	4,44	5,18	5,92	6,66	7,40	
lux	3.200K	CRI 97.5	TLCI 95.3									
	5.600K	CRI 96.8	TLCI 96.7									

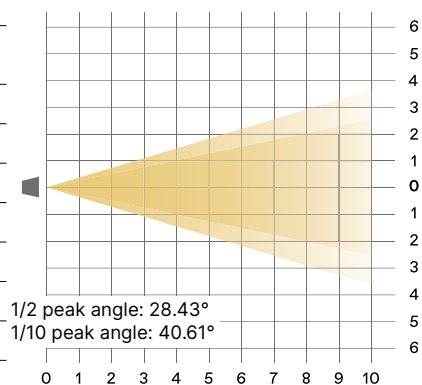

Otello 6 HD FullSpectrum +

Optic: Maximum Zoom

Distance(m)		1	2	3	4	5	6	7	8	9	10
lux	RED	1.788	447	199	112	72	50	36	28	22	18
	GREEN	2.800	700	311	175	112	78	57	44	35	28
	BLUE	600	150	67	38	24	17	12	9	7	6
	CYAN	1.704	426	189	107	68	47	35	27	21	17
	LIME	7.832	1.958	870	490	313	218	160	122	97	78
	AMBER	4.672	1.168	519	292	187	130	95	73	58	47
	FULL	10.616	2.654	1.180	664	425	295	217	166	131	106
	3.200K	11.552	2.888	1.284	722	462	321	236	181	143	116
	5.600K	11.964	2.991	1.329	748	479	332	244	187	148	120

1/2 P.A. Ø (m)	0,79	1,58	2,36	3,15	3,94	4,73	5,51	6,30	7,09	7,88
1/10 P.A. Ø (m)	1,27	2,55	3,82	5,10	6,37	7,64	8,92	10,19	11,47	12,74
lux	3.200K	CRI 97.5	TLCI 95.1							
	5.600K	CRI 96.5	TLCI 96.5							

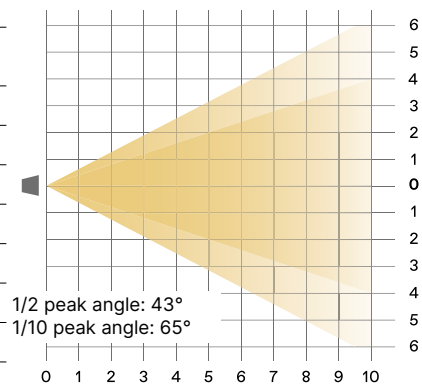

● Coemar Lighting S.r.l.

Via Carpenedolo, 90
46043, Castiglione delle Stiviere (MN) – Italy

P. +39 0376 1514412

M1. info@coemar.com

M2. service@coemar.com

W. coemar.com

P.iva – C.f. 02415330204



Coemar reserves the right to change specifications without prior notice.

Last Update: 29 March 2023 - vrs. 1.9