



# DATASHEET

## Charging Case for AX2

Compatible with:  
AX2-50 or AX2-100



This sturdy flight case can charge 8 AX2-50 or 4 AX2-100 through the integrated charging box from one AC socket. Dedicated spaces for barndoors, brackets and additional side compartment for other accessories.



## SPECIFICATIONS

Order Code	AX2-50-CHRCSE	AX2-100-CHRCSE
Input		
Input Current		
Ouput		
Dimensions (mm/inch)	1190 x 588 x 468 / 46.9 x 22.8 x 21.3	1190 x 588 x 468 / 46.9 x 22.8 x 21.3
Weight empty (kg/lbs)	53.5 / 117.9	50.5 / 111.3
Weight full (kg/lbs)	111.5 / 245.8	96 / 211.6
Connectors/Cables		
Material	Plywood, Aluminium	Plywood, Aluminium

## CAN HOLD

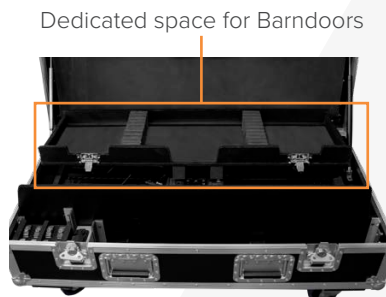

Dedicated space for Barndoors



8x PixelBar 50 (not included)  
(AX2-50)



4x PixelBar 100 (not included)  
(AX2-100)



1x ChargingHarness (included)  
(AX2-50-CHRCSE-CHH)



1x ChargingHarness (included)  
(AX2-100-CHRCSE-CHH)



16x TrackPin (not included)  
(AX-TP)



8x TrackPin (not included)  
(AX-TP)



16x Barndoor (not included)  
(AX2-50-BD)



8x Barndoor (not included)  
(AX2-100-BD)



16x Brackets (not included)



8x Brackets (not included)



8x PowerCon True1 cable (included)



4x PowerCon True1 cable (included)



8x FlyBar (not included)  
(AX-TP)



4x FlyBar (not included)  
(AX-TP)



8x JumpCable (not included)  
(AX-JC)



4x JumpCable (not included)  
(AX-JC)

# DRAWINGS

## AX2-50

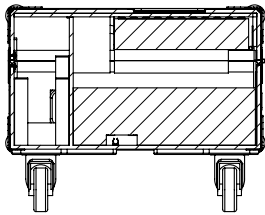

SECTION A

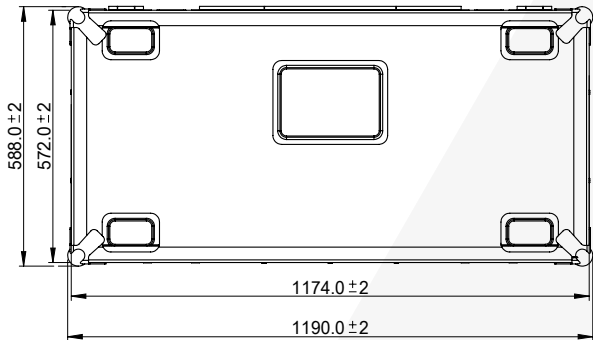
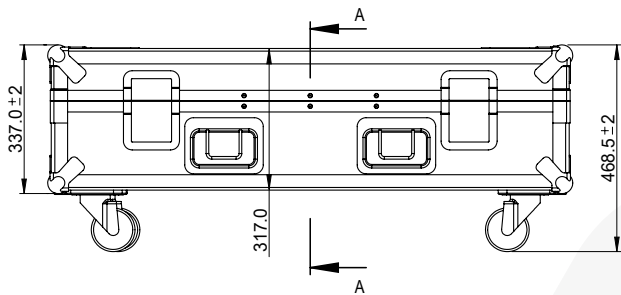

## AX2-100

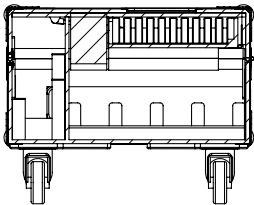

Section A

